

Plant valves

VG9000

DN15...100, PN6 and PN10

These flanged valves are primarily designed to regulate the flow of water and low pressure steam in response to the demand of a controller, in Heating, Ventilating and Air Conditioning (HVAC) systems.

Following electric actuators are available:

VA-7700 for DN15...50 valves

VA7810 for DN15...65 valves

VA1000 for DN65...100 valves.

Features

- ▶ Nodular cast iron body
- ▶ K_{VS} 0.63...160
- ▶ 2-way PDT0 (normally closed) and 3-way mixing configurations
- ▶ Fluid temperature 2...140 °C
- ▶ DIN flanged

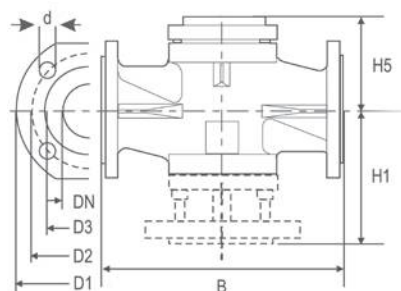

Dimensions in mm

Body Size	PN6							PN10						
	B	D1	D2	D3	d	H1	Holes	B	D1	D2	D3	d	H1	Holes
DN15	130	80	55	38	11	65	4	130	95	65	46	14	65	4
DN20	140	90	65	48	11	70	4	150	105	75	56	14	75	4
DN25	150	100	75	58	11	75	4	160	115	85	65	14	80	4
DN32	180	120	90	69	14	90	4	180	140	100	76	19	90	4
DN40	180	130	100	78	14	90	4	200	150	110	84	19	100	4
DN50	200	140	110	88	14	100	4	230	165	125	99	19	115	4
DN65	240	160	130	108	14	120	4	290	185	145	118	19	145	4
DN80	260	190	150	124	19	130	4	310	200	160	132	19	155	8
DN100	300	210	170	144	19	150	4	350	220	180	156	19	175	8

Plant Valves

VG9000
Ordering information
PN6 series (VG9xxxS1K)

Codes*	Body size	K _{VS}	Close-off pressure kPa					
			RA-3000-732x 3000 N	VA-1x20-GGA-1** 2000 N	VA-1125-GGA-1** 2500 N	VA-77xx-820x 500 N	VA78xx-xxx-12 1000 N	
2-way PDT0 (Normally Closed) configuration								
VG94A5S1K	DN15	0.63	---	---	---	600	600	
VG94A4S1K		1.0						
VG94A3S1K		1.6						
VG94A2S1K		2.5						
VG94A1S1K		4.0						
VG94B1S1K	DN20	6.3	---	---	---	590	600	
VG94C1S1K	DN25	10						
VG94E2S1K	DN32	16						
VG94E1S1K	DN40	25						
VG94F1S1K	DN50	40						
VG94G1S1K	DN65	63	470	620	---	---	150	
VG94H1S1K	DN80	100	510	300			400	---
VG94J1S1K	DN100	160	320	180			240	---
3-way mixing configuration								
VG98A5S1K	DN15	0.63	---	---	---	600	600	
VG98A4S1K		1.0						
VG98A3S1K		1.6						
VG98A2S1K		2.5						
VG98A1S1K		4.0						
VG98B1S1K	DN20	6.3	---	---	---	490	600	
VG98C1S1K	DN25	10						
VG98E2S1K	DN32	16						
VG98E1S1K	DN40	25						
VG98F1S1K	DN50	40						
VG98G1S1K	DN65	63	470	620	---	---	130	
VG98H1S1K	DN80	100	510	300			400	---
VG98J1S1K	DN100	160	320	180			240	---

Notes

* For factory mounted valve actuators just add "+M" to the actuator ordering code.

** For fluid temperature >140 °C the extension kit VA1000-EP must be mounted.

Plant valves

VG9000
Ordering information
PN10 series (VG9xxxS1L)

Codes*	Body size	K _{VS}	Close-off pressure kPa							
			RA-3000-732x 3000 N	VA-1x20-GGA-1** 2000 N	VA-1125-GGA-1** 2500 N	VA-77xx-820x 500 N	VA78xx-xxx-12 1000 N			
2-way PDTO (Normally Closed) configuration										
VG94A5S1L	DN15	0.63	---	---	---	1000	1000			
VG94A4S1L		1.0								
VG94A3S1L		1.6								
VG94A2S1L		2.5								
VG94A1S1L		4.0								
VG94B1S1L	DN20	6.3				980				
VG94C1S1L	DN25	10						640		
VG94E2S1L	DN32	16				400		900		
VG94E1S1L	DN40	25				210		510		
VG94F1S1L	DN50	40				110		310		
VG94G1S1L	DN65	63				470		620	---	160
VG94H1S1L	DN80	100				510		300		400
VG94J1S1L	DN100	160				320		180	240	---
3-way Mixing configuration										
VG98A5S1L	DN15	0.63	---	---	---	1000	1000			
VG98A4S1L		1.0								
VG98A3S1L		1.6								
VG98A2S1L		2.5								
VG98A1S1L		4.0								
VG98B1S1L	DN20	6.3				880				
VG98C1S1L	DN25	10						430		
VG98E2S1L	DN32	16				240		790		
VG98E1S1L	DN40	25				110		420		
VG98F1S1L	DN50	40				40		240		
VG98G1S1L	DN65	63				470		620	---	120
VG98H1S1L	DN80	100				510		300		400
VG98J1S1L	DN100	160				320		180	240	---

Notes

* For factory mounted valve actuators just add "+M" to the actuator ordering code.

** For fluid temperature >140 °C the extension Lit VA1000-EP must be mounted.